

Note: Rear triangle should fall by itself after assembly!

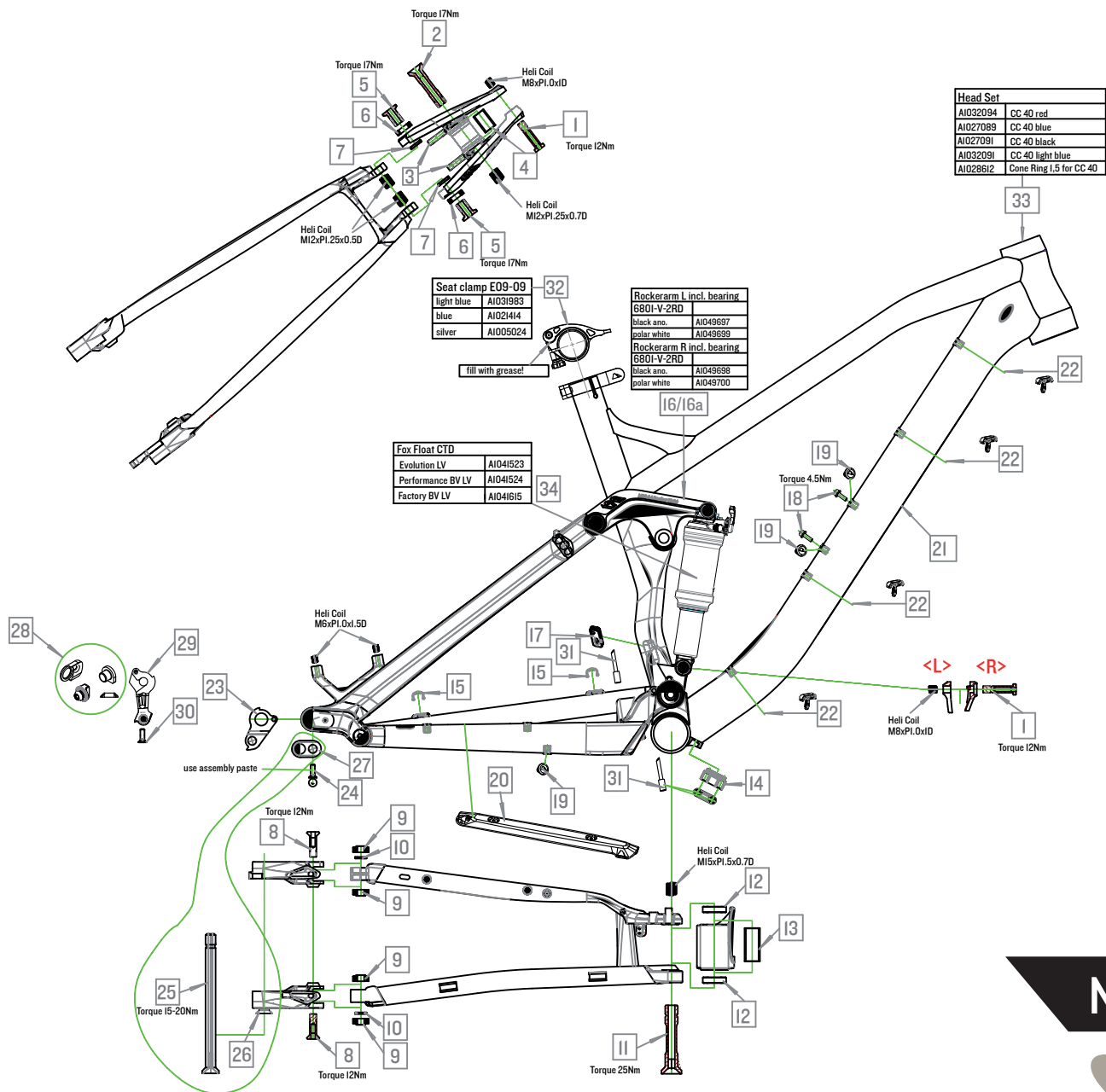

	Canyon#	Part Name	Qty.
1	AI043776	shock bolt	2PCS
2	AI043777	axle for rocker arm pivot	IPC
3	AI035330	bearing 7901-V-2RD	2PCS
4	AI043778	spacer ST-pivot	IPC
5	AI043779	pivot bolt	2PCS
6	AI038902	bearing 6801-V-2RD	2PCS
7	AI043780	pivot spacer	2PCS
8	AI043781	horstlink bolt	2PCS
9	AI043782	bearing 698-V-2RD-1.5	4PCS
10	AI043783	horstlink spacer	2PCS
11	AI043784	main pivot axle	IPC
12	AI029862	bearing 7902-V-2RD	2PCS
13	AI043785	spacer main pivot	IPC
14	AI042777	Cable guide E24-14	IPC
15	AI012043	Cable Clip II-101-777	2PCS
16	see drawing	Rockerarm L incl. bearing	ISET
16a	see drawing	Rockerarm R incl. bearing	ISET
17	AI028806	clip-in cable guide E99-12	IPC
18	AI033271	water bottle screw	2PCS
19	AI016702	blind plug E40-10	3PCS
20	AI043786	C/S protector incl. screws EI70-14	ISET
21	AI043787	protection foil D/T	IPC
22	AI042618	double cable-clip EI95-14	4PCS
23	AI038695	RD-hanger # 26 for SRAM	IPC
24		incl. screws	IPC
23	AI038715	RD-hanger # 27 for Shimano direct mount	IPC
24		incl. screws	IPC
25		Canyon through axle	IPC
26	AI040927	conic steel washer EI72-14	IPC
27		DO chip	IPC
28	AI041958	DO-Adapter kit for QR skewer EI73-14	ISET
29	AI043011	RD-hanger # 29 only for Shimano direct mount	IPC
30		incl. screws	IPC
31	AI013141	Jagwire nose ferrule	3PCS
32	see drawing	Seat clamp E09-09	ISET
33	see drawing	Head Set	ISET
34	see drawing	Fox RP	ISET